

+GF+ SIGNET 5500 ProPoint™ Flow Monitor



Description

The +GF+ SIGNET 5500 Flow Monitor is equipped with a scaleable 4 to 20 mA output and two relays programmable for high, low, and pulse operation. Instantaneous flow rate is easy to read on the analog dial, while the backlit LCD is used for calibration, set-up and displaying totalized flow volumes. One of the two totalizers is resettable from the front panel, and can also be reset from a remote location up to 30 m. (100 ft). The other totalizer is non-resettable and is

commonly used to tally consumption, or to permanently record industrial effluent volumes. The monitors require 12 to 24 Volts, AC or DC, and can be used with any +GF+ SIGNET Flow Sensor with a frequency output. Our intuitive software design and four-button keypad arrangement provide for simple operation, and the NEMA 4X/IP65 integrity of the front panel can be extended to the entire enclosure by using the optional Rear Cover Kit.

Technical Features

Pro-Point Family Features

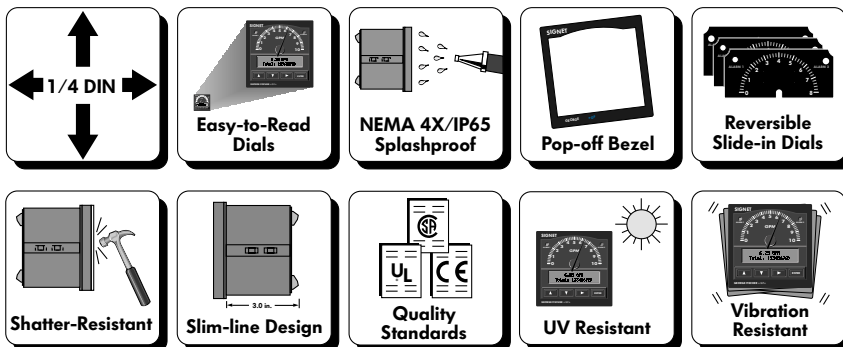

Features

- Analog and Digital display
- Two 8-digit Totalizers: one permanent, the other resettable
- Two Programmable Relays
- Fully Scaleable 4 to 20 mA Output
- Tamper proof security code
- Non-volatile memory
- Intuitive Software Design
- Simple push-button operation
- Programmable pulse outputs
- 1/4 DIN, NEMA 4X/IP65 enclosure
- Quality Standards: UL, CSA, CE

Application

- Waste Water Flow Accumulation
- Water Treatment Systems
- Filtration Systems
- Feed Pump Pulsing
- Fertigation
- Irrigation
- Commercial Pools & Spas
- Groundwater Remediation
- HVAC
- Process Flow Monitoring
- UPW Distribution
- Demineralizer Regeneration
- Process Cooling Water
- Neutralization Systems

Options

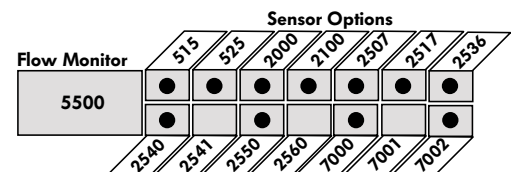

Dimensions

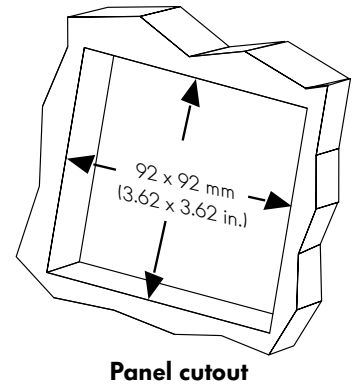
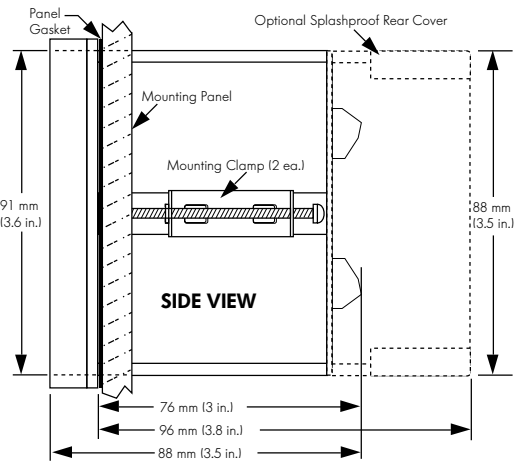
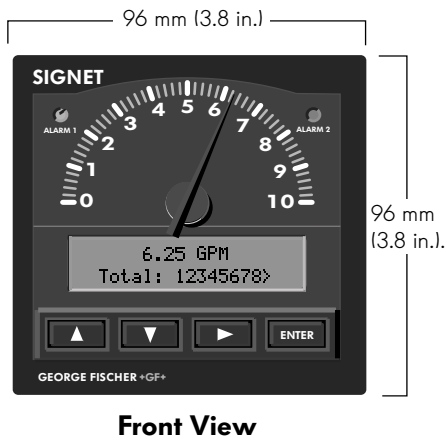

Installation

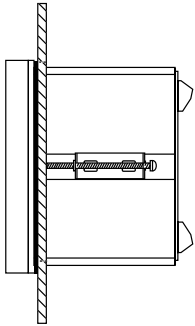

- Panel mount (standard)

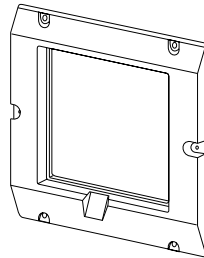

- Optional 5 x 5 inch adapter plate for SIGNET retrofit (3-5000.399)

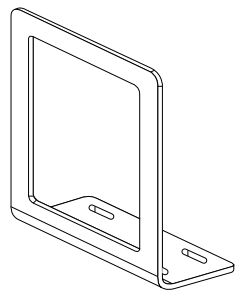

- Optional surface mounting bracket (3-5000.598)

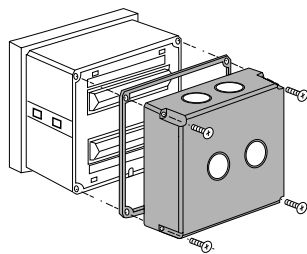

- Optional splashproof rear cover kit (NEMA 4X/IP65) (3-5000.395)

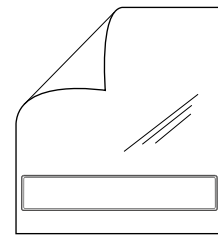

- Protective Overlay kit (10 pcs) (3-5000.398)

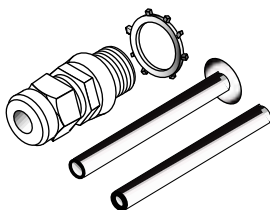

- Liquid Tight Connector Kit (3-9000.392 - 3 sets per kit) (3-9000.392-1 - 1 set per kit)

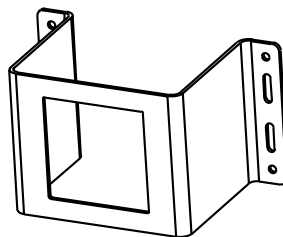

- Optional heavy duty wall mount bracket (3-0000.596)

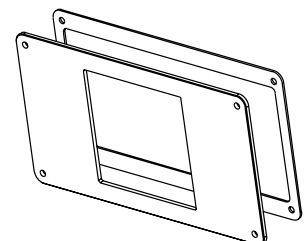

- Optional 200 retrofit adapter (3-8050.392)

Rear Terminal View

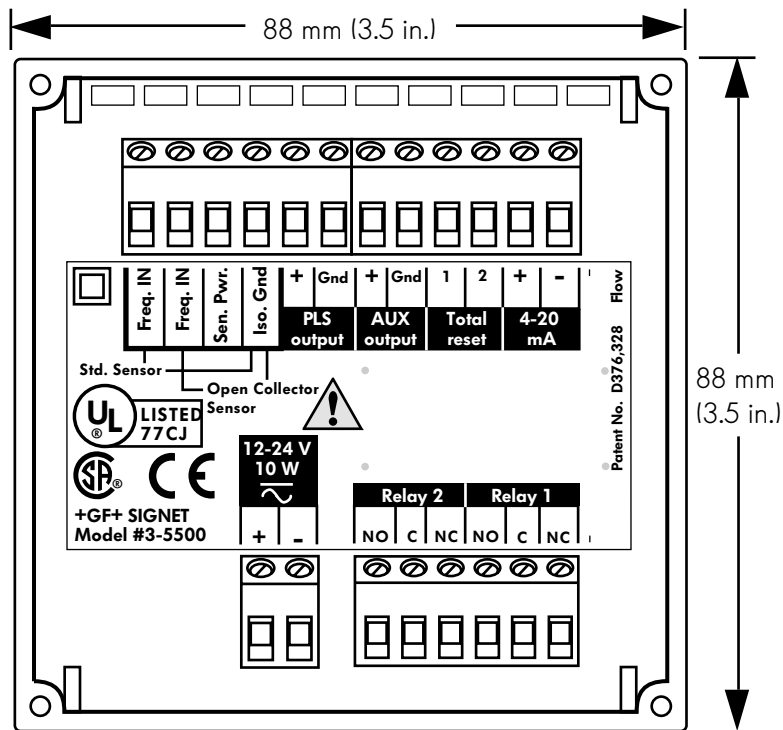

Technical Data

General

Operating Range:	0.5 Hz to 10kHz
Power Requirements:	12 to 24 Volts, AC or DC, unregulated, 50 to 60 Hz, 10W max.
Display:	Analog: Six slide-in dial ranges: 0 to 2, 4, 6, 8, 10 & 100 w/multipliers Digital: Backlit LCD, 2x16 alphanumeric character
Current Output:	4 to 20 mA, non-isolated, internally powered Loop impedance: 350Ω max. @ 12V, 950Ω max. @ 24V Accuracy: +/- 0.1% Update rate: 100 msec
Alarm Contacts:	Two SPDT relays: Hi/Lo/Pulse programmable with adj. hysteresis 5A @ 30VDC, 5A 125VAC, or 3A @ 250VAC max.
Additional Functions:	Sensor pulse output, volumetric auxiliary pulse output, remote totalizer reset
Accuracy:	± 0.5% of reading
Materials:	Enclosure: ABS Plastic, NEMA 4X/IP65 Keypad: Silicone Rubber Panel and case gasket: Neoprene Window: Hard-coated polycarbonate
Shipping Weight:	0.8 kg (1.8 lbs.)

Environmental

Operating temperature:	-10 to 55° C (14 to 131° F)
Relative humidity:	0 to 95%, non-condensing

Standards and Approvals

- UL, CSA, CE
- Manufactured under ISO 9001 and ISO 14001
- Immunity: EN50082-2
- Emissions: EN55011
- Safety: EN61010-1

Ordering Information

Mfr. Part No.	Code	Description
3-5500	198 825 002	<ul style="list-style-type: none">• 5500 Flow Monitor• Reversible dial face kit included (0-2, 4, 6, 8, 10, 100)• Assorted flow rate/multiplier decals included

Accessories

Mfr. Part No.	Code	Description
3-5000.395	198 840 227	Splashproof rear cover (NEMA 4X/IP65)
3-5000.399	198 840 224	5 x 5 inch adapter plate for +GF+ SIGNET product retrofit
3-5000.598	198 840 225	Surface mount bracket
3-9000.392	159 000 368	Liquid tight connector kit for rear cover (includes 3 connectors)
3-9000.392-1	159 000 839	Liquid tight connector kit, NPT (1 piece)
3-9000.392-2	159 000 841	Liquid tight connector kit, PG13.5 (1 piece)
3-8050.392	159 000 640	Model 200 retrofit adapter
3-0000.596	159 000 641	Heavy duty wall mount bracket
3-5000.390	159 000 232	Installation kit
3-5000.525-1	198 840 226	Bezel, 5000 series
3-5500.390	159 000 347	Dial kit
3-5500.611	198 840 230	Unit tags
3-5000.397	159 000 326	5000 Series Window
3-5000.398	159 000 646	Protective Overlay kit (10 pcs.)
3-5000.075	159 000 321	110V/24V Transformer

Engineering Specifications

- The flow monitor shall meet appropriate CSA, UL and CE standards, including EN50082-2 requirements for electromagnetic immunity, EN55011 requirements for electromagnetic emissions, and EN61010-1 for safety.
- The flow monitor shall be manufactured under ISO 9001 and ISO 14001 certified processes.
- The flow monitor shall accept sinusoidal or digital pulse trains from 0.5 Hz to 10kHz.
- The flow monitor shall accumulate flow units in one permanent and one resettable totalizer. Totalizers shall retain readings from 0 to 99,999,999
- Flow rate and flow totalizers shall be calibrated independently.
- The flow monitor shall provide additional functions including: Two SPDT Relays, Sensor Pulse, Count Pulse and Remote Totalizer Reset.
- The flow monitor shall be programmable with front panel keys for calibration, to set relay functions, to set K-factor from 0.001 to 99,999, to select flow range and to select engineering units. Front panel keys shall also select display functions and reset resettable totalizers.
- The flow monitor shall provide an analog flow rate indicator which shall accept replaceable dial faces, provided by the manufacturer, to display a variety of engineering units in ranges including: 0-2; 0-4; 0-6; 0-8; 0-10; and 0-100 with multiply or divide by indication.
- Analog display accuracy shall be $\pm 1\%$ of reading; digital display accuracy shall be $\pm 0.5\%$ of reading.
- The flow monitor shall provide an analog flow rate indicator and a digital display capable of showing flow rate and totalized flow volume simultaneously.
- The flow monitor shall provide an optically isolated frequency output with an output range from 0.5Hz to 10kHz.
- The flow monitor shall provide a 4 to 20 mA non-isolated, internally powered two-wire current loop output.
- The flow monitor shall be compatible with all +GF+ SIGNET powered and non-powered flow sensors with frequency outputs.
- The flow monitor shall be +GF+ SIGNET 5500 Flow Monitor.